



Francis Howell North High School  
Construction Update  
May 2022

# Monthly Construction Update – 801 Corporate Highlights

- Painting has started on the 2<sup>nd</sup> floor (Union)
- Drywall has started on the 3<sup>rd</sup> floor
- Ceiling grid and electrical finish is moving forward on the 2<sup>nd</sup> floor (Union)
- Moving coordination has started
- Anticipated completion - summer 2022
  - Union will start the 2022-23 school year in the new building

# Construction Activity

## 801 Corporate



# Monthly Construction Update FHN

## Upcoming Highlights May 2022

- Major structural steel in the Main and Auxiliary Gym is scheduled for erection in early May.
- Auditorium storm shelter deliveries and installation of the precast panels is underway.
- CMU block installation is scheduled to start in the lower level classrooms, stairwells and elevator shafts.
- Exterior metal framing is scheduled to begin in the lower level classroom area.
- East classroom wing elevated slab is scheduled to be poured early May with the west classroom wing to follow late May.
- Lower level door frames are scheduled for delivery at the end of this month.

# Construction Activity:

## Site Overview May 2022





# Construction Activity: Structural Steel Installation at Classroom Wings



# Construction Activity: Auxiliary Gym & Main Gym CMU



# Construction Activity: Main Gym Structural Steel





# Construction Activity: Main Level Finish Concrete & CMU Fire Walls



# Construction Activity: Conduit Installation on Subgrade in Admin Area



# Construction Activity: Finish Concrete Pour North Side of Gym



# Construction Activity: Precast Panels in the Auditorium Storm Shelter





# Construction Activity: Drone Flight May 2022



# Francis Howell North High School Budget Dashboard: May 2022

## GMP Value Billed to Date

### Allowances

Escalation Allowance

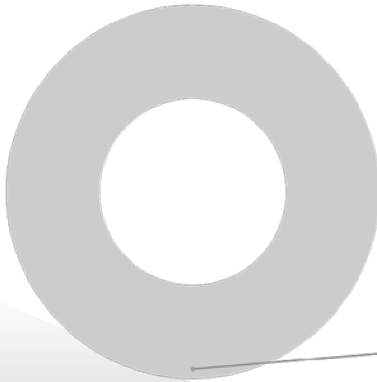

Available  
100.0%

GMP Allowance (99%-100%) DWGs.

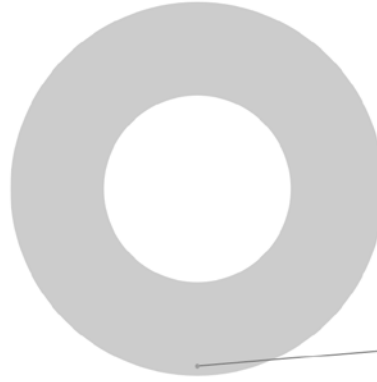

Available  
100.0%

Billed To Date  
19.0%

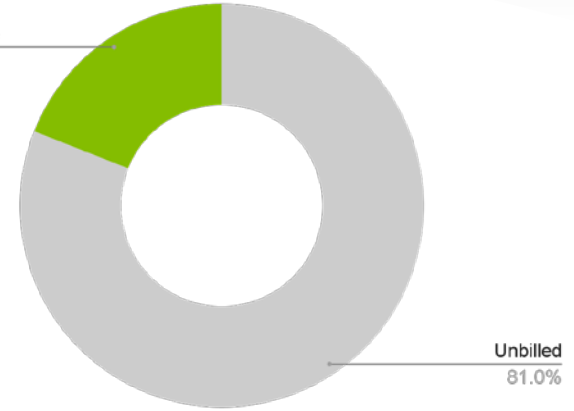

Unbilled  
81.0%

GMP Total: \$164,723,000  
Billed to date: \$20,770,209



Escalation Allowance:  
\$1,120,180  
Used to date: \$0

GMP Allowance:  
\$1,120,180  
Used to date: \$0

## Prop S Project Approval Process

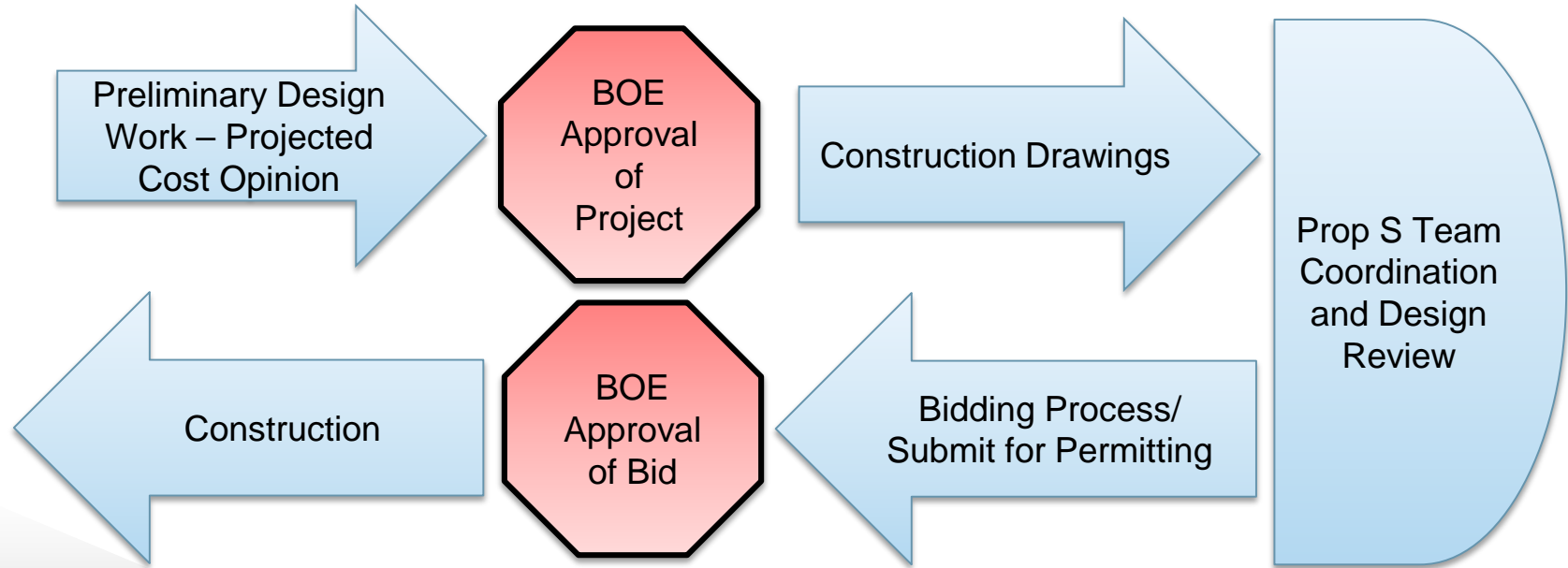



Francis Howell School District  
Transportation Facility  
Design Update  
May 2022



# Transportation Facility Background

- Current St. Peters-Howell Rd facilities greatly in need of replacement
- Transportation Facility replacement was part of larger plan
- Plan call for creative reuse of current Administration Building
- Current plan only addresses a portion of the contemplated work



## SCHEMATIC SITE PLAN (ENLARGED)

SK 1.0A



**HOENER ASSOCIATES, INC.**  
ARCHITECTS ST. LOUIS, MISSOURI  
DATE ISSUED 04-09-21 PROJ. NO. 20-17E

### FHSD TRANSPORTATION FACILITY

FRANCIS HOWELL SCHOOL DISTRICT  
ST. CHARLES COUNTY, MISSOURI

#### REVISION DATES

|          |          |
|----------|----------|
| 05-13-21 | 04-06-22 |
| 03-30-22 | 04-28-22 |

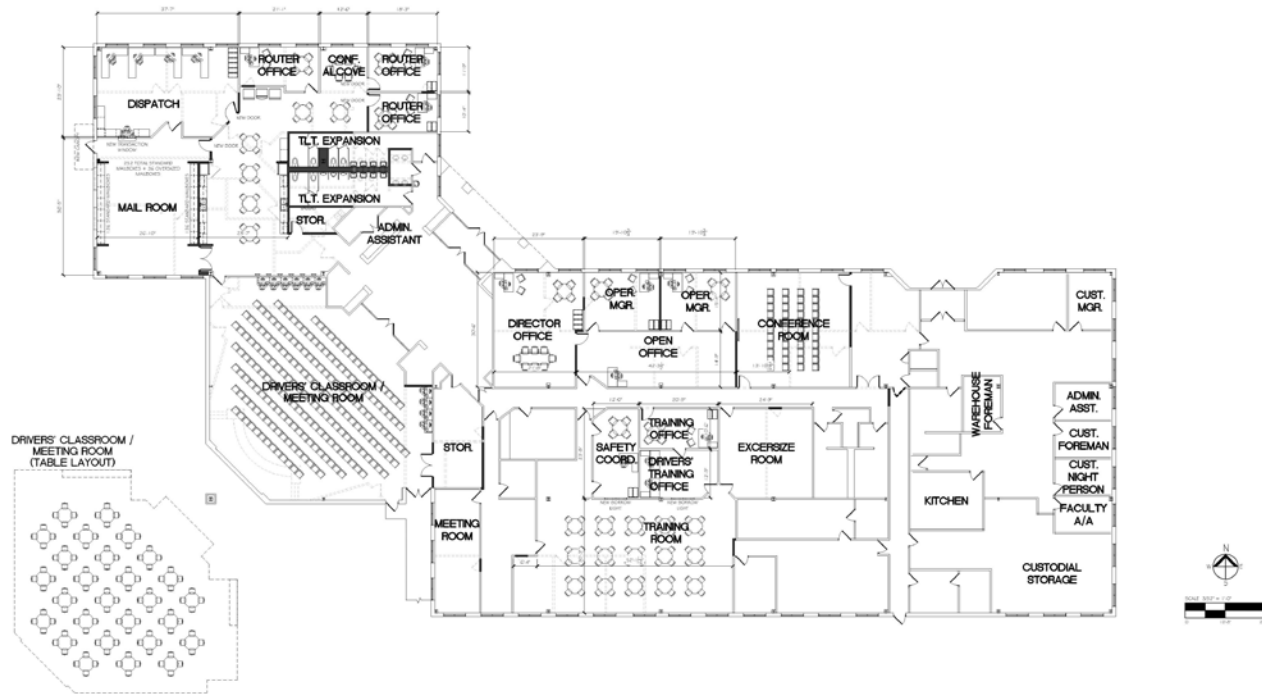

## SCHEMATIC FLOOR PLAN

SK 1.1



**HOENER ASSOCIATES, INC.**  
ARCHITECTS ST. LOUIS, MISSOURI  
DATE ISSUED 02-25-21 PROJ. NO. 20-17E

### FHSD TRANSPORTATION FACILITY

FRANCIS HOWELL SCHOOL DISTRICT  
ST. CHARLES COUNTY, MISSOURI

#### REVISION DATES

|          |          |
|----------|----------|
| 01-19-22 | 04-06-22 |
| 03-30-22 | 04-28-22 |

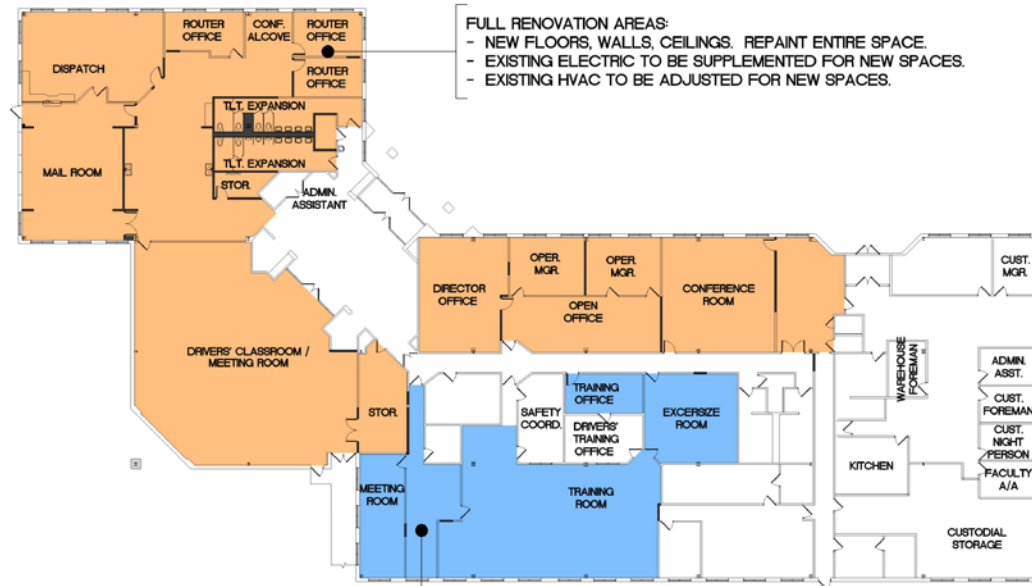

## SCHEMATIC FLOOR PLAN - RENOVATION DIAGRAM

SK 1.2



**HOENER ASSOCIATES, INC.**  
ARCHITECTS ST. LOUIS, MISSOURI  
DATE ISSUED PROJ. NO.  
20-17E

### FHSD TRANSPORTATION FACILITY

FRANCIS HOWELL SCHOOL DISTRICT  
ST. CHARLES COUNTY, MISSOURI

#### REVISION DATES

|  |  |
|--|--|
|  |  |
|  |  |



# Opinion of Probable Cost

|   | Description of Work                     | Area             | Cost/SF   | Sub-Total           | Cost of Work        |
|---|---|------------------|-----------|---------------------|---------------------|
| 1 | Proposed <b>Full</b> Renovation Area    | 12,000 SF        | \$ 75 /SF | \$ 900,000          |                     |
| 2 | Proposed <b>Partial</b> Renovation Area | 4,000 SF         | \$ 30 /SF | \$ 120,000          |                     |
| 3 | Site Work (Sidewalk to Bus Lot)         | 1                | Allowance | \$ 100,000          |                     |
| 4 | <b>Total Construction Cost</b>          | <b>16,000 SF</b> |           | <b>\$ 1,120,000</b> |                     |
| 5 | Project Contingency                     | 5%               |           | \$ 56,000           |                     |
| 6 | Sub-Total                               |                  |           |                     | \$ 1,176,000        |
| 7 | Project Soft Cost                       | 10%              | Estimate  |                     | \$ 117,600          |
| 8 | <b>PROJECT TOTAL</b>                    |                  |           |                     | <b>\$ 1,293,600</b> |